

Gompei's Gears Bike Check-out and Return Instructions

Once you are at the bike location at which you would like to check out a bike:

1. Ensure that your location services and Bluetooth are on.
2. Open Movatic on your phone.

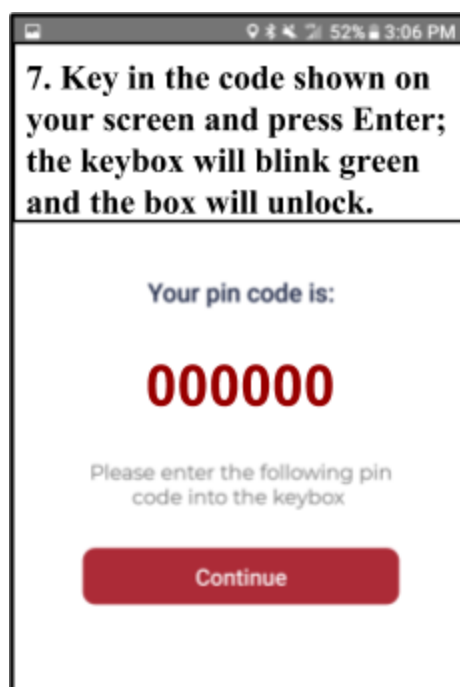
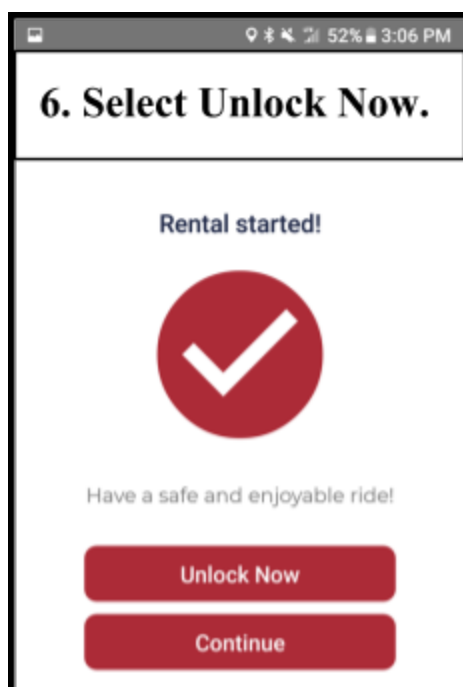
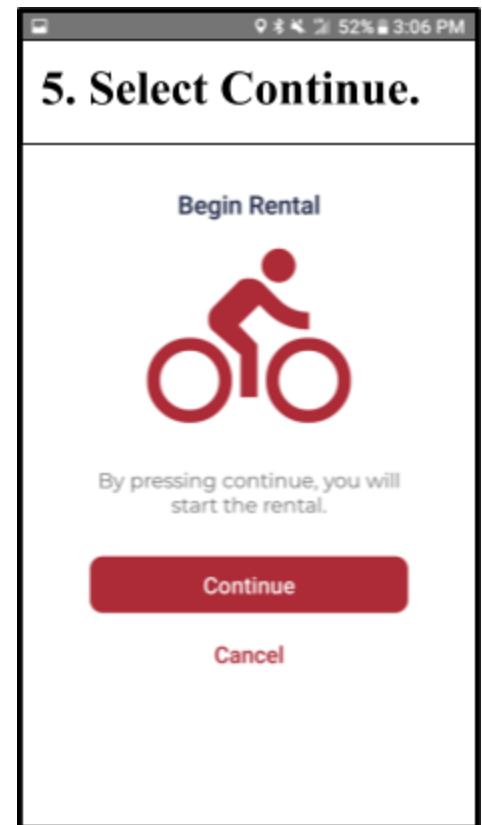
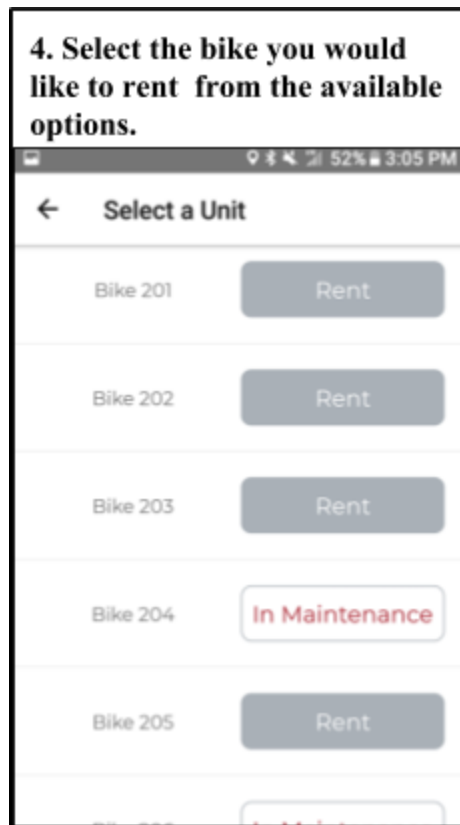
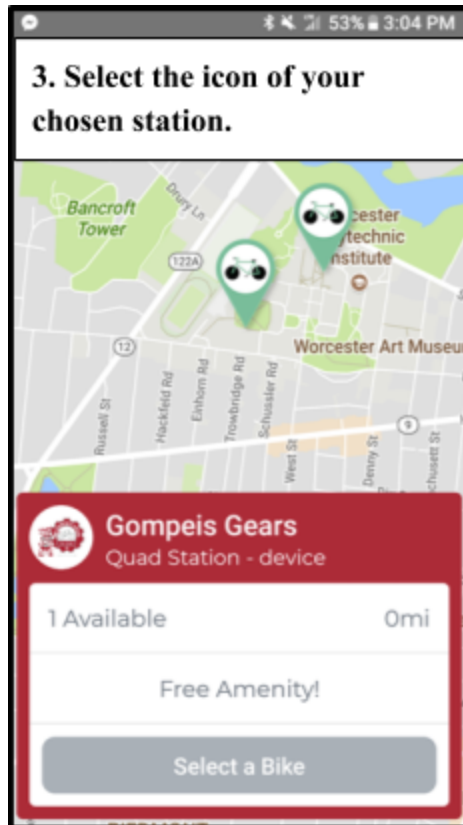

8. Slide the metal lock down and pull to open.

9. Take the key.

10. Close the box and slide the lock back up to lock it.

11. Insert the key into your bike and twist to unlock the U-lock. The key will stay in the bike while you are riding; the U-lock may be placed in the holder on the back wheel until you need to lock the bike at your next stop.

Return Instructions:

1. When you are finished riding, return to your original bike rack.
2. Prop the bike next to the rack with the kickstand, insert the U-lock around the rack into the bike, and remove the key.

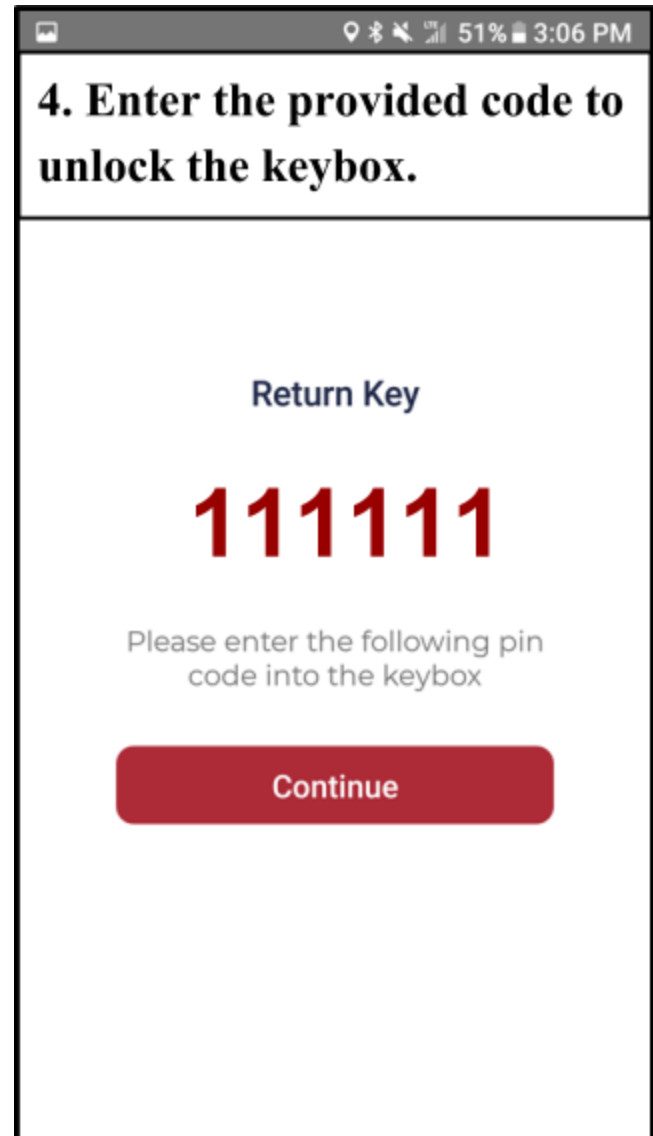
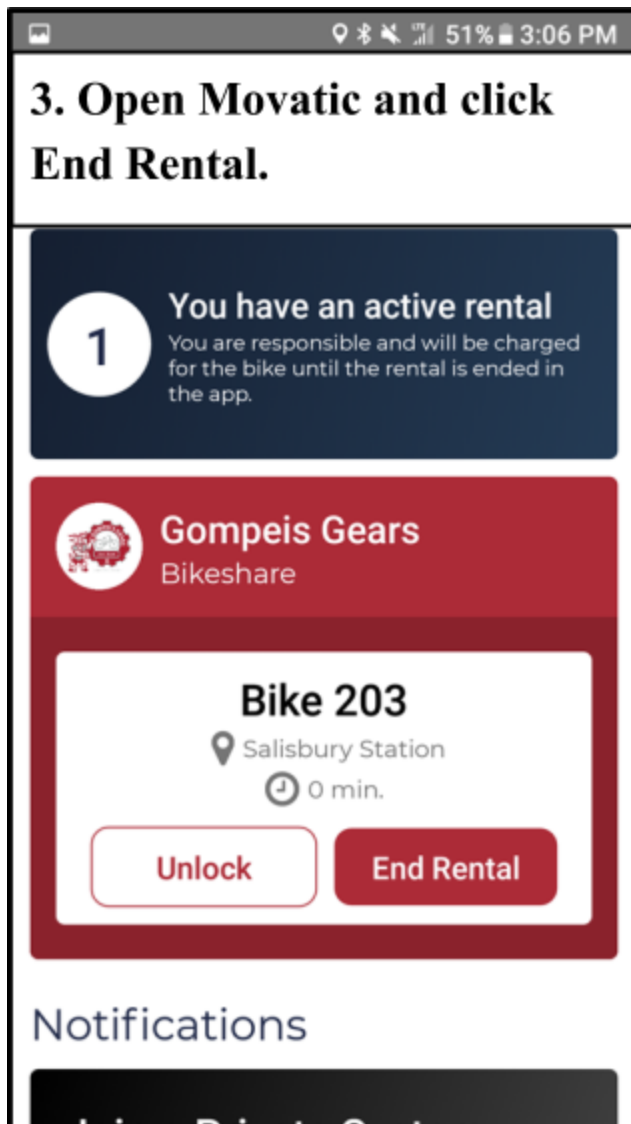

5. Slide the lock down and pull the box to open.
6. Replace the key in the box.
7. Close the box and slide the lock up to lock.
8. Click Continue within the Movatic app and you're all set!

We hope you enjoy your experience and thank you for riding with Gompei's Gears!